



BUILDING DEPARTMENT
11800 TOWN CENTER DRIVE NE, SUITE 300
ST. MICHAEL, MN 55376
763-497-9923
INSPECTIONS@STMICHAELMN.GOV

DECKS

This handout is intended only as a guide and is based in part on the 2012 Minnesota State Building Code, St. Michael City ordinances, and good building practice. While every attempt has been made to insure the correctness of this handout, no guarantees are made to its accuracy or completeness. Responsibility for compliance with applicable codes and ordinances falls on the owner or contractor. For specific questions regarding code requirements, refer to the applicable codes or contact your local Building Department.

The following are examples of information that should be included on plans submitted for building permits for residential decks. They are **examples only** and should not be construed as being code compliant for every application. It is the responsibility of the homeowner or person preparing the plans to show in detail how they will build their deck. Some designs may require more detail than others.

Your deck plans should replicate exactly how you will build your deck. We will review your plans before we issue the building permit to identify code violations before you start work. The more detailed your plans, the more likely you avoid corrections in the field.

When you receive your permit, you will also be given one set of plans stamped "Approved". Once your plans are approved, you should not change your design without approval by the St. Michael Building Department. **You should read through the approved plans to determine if the plan reviewer noted any corrections to your plan.** If you have any questions regarding any of the corrections, you should contact us before proceeding.

Plans created at home centers are not acceptable for plan review. These computer designs do not allow homeowners to duplicate conditions at their home. Applications submitted with these types of plans will be returned to the applicant.

REQUIRED INFORMATION WHEN APPLYING FOR A PERMIT: We will not accept computer generated plans from retail home centers as they are material lists for estimating purposes only. Deck plans shall be site specific to your property.

- A. Submit 2 copies of a Certificate of Survey or 2 Copies of a plot plan drawn to scale indicating the lot dimensions, the location and ground coverage area of existing structure(s), and the location and area of the proposed structure. Indicate the setbacks from property lines.
- B. Submit 2 copies of drawings showing proposed designs and materials. Drawings shall be drawn to scale and shall include the following information.
- C. Floor Plans shall include the following:
 - Indicate proposed deck size.
 - Indicate size and spacing of floor joists.
 - Indicate size, location, and spacing of posts.
 - Indicate stair stringer spacing.
 - Indicate size of headers/beams.
 - Indicate specific decking material.
- D. Cross Section of either a rear or side view shall include the following:
 - Diameter and depth of footings.
 - Size of posts.
 - Header size supporting floor joists.
 - Floor joists size and spacing.
 - Flooring material.
 - Guardrail height (if any).
 - Type of lumber to be used.
 - Provide detail of beam to post connection, deck ledger connection, flashing detail. and stairway rise and run (see attached samples 1, 2, and 3).
- E. Checklist attached to the end of this handout must be completed before submitting permit application.

RESIDENTIAL DECKS

Information Sheet

Building Permits	Permits are required for any deck attached to your home. Check with the building and zoning department for any detached decks.
Setbacks	Building code and zoning requirements apply. Contact the zoning department for setback requirements for your property.
Frost Footings	Required for any deck attached to an existing dwelling, porch or garage that has frost footings. The minimum depth to the base of the footing is 42". See frost depth rules in the Minnesota State Building Code.
Live Load	All decks shall be designed to support a live load of 40 pounds per square foot.
Guards	Required on all decks more than 30 inches above grade or a lower deck. Rail shall be 36 inches minimum in height. Guardrails must have intermediate rails or an ornamental pattern that a 4" sphere cannot pass through, stair railings must have 4 3/8" spacing. The triangular openings formed by the riser, tread and bottom element of a guard may be sized so that a 6 inch sphere cannot pass through.
Cantilevers "Overhanging Joists and Beams"	Joists shall not overhang beams by more than two feet, nor shall beams overhang posts by more than one foot unless a special design is approved.
Flashing	All connections between deck and dwelling shall be weatherproof. Any cuts in exterior finish shall be flashed.
Framing Details	Header beams and joists that frame into ledgers or beams shall be supported by approved framing anchors such as joist hangers.
Nails and Screws	Use only stainless steel, high strength aluminum or hot-dipped galvanized.
Wood Required	All exposed wood used in the construction of decks is required to be of approved wood of natural resistance to decay (redwood, cedar, etc.) or approved treated wood. This includes posts, beams, joists, decking and railings.
Stairs	<p>Minimum width is 36 inches. Maximum rise is 7 3/4 inches, minimum rise is 4 inches. Minimum run is 10 inches. Largest tread width or riser height shall not exceed the smallest by more than 3/8 inch <u>within</u> any flight of stairs.</p> <p>All interior and exterior stairways shall be provided with a means to illuminate the stairs, including the landings and treads. Interior stairways shall be provided with an artificial light source located in the immediate vicinity of each landing of the stairway. Exterior stairways shall be provided with an artificial light source located in the immediate vicinity of the top landing of the stairway. Exterior stairways providing access to a basement from the outside grade level shall be provided with an artificial light source located in the immediate vicinity of the bottom landing of the stairway. The illumination of exterior stairs shall be controlled from inside the dwelling unit.</p>
Handrails	The top shall be placed not less than 34 inches or more than 38 inches above the nosing of the treads. Stairways having four or more risers shall have at least one handrail. Handrail ends shall be returned or terminated in posts. The hand grips shall not be less than 1 1/4 inches or more than 2 5/8 inches in cross-sectional dimension or the shape shall provide an equivalent gripping surface. The handgrip shall have a smooth surface with no sharp corners.
Special	Some deck designs may not be appropriate should the placement of a screen porch or 3-season porch on the deck platform be a future consideration.

Beam and Footing Sizes

Based on No. 2 or better Ponderosa Pine and Southern Pine
(treated for weather and/or ground exposure)

		Post Spacing														
		4'	5'	6'	7'	8'	9'	10'	11'	12'	13'	14'				
JOIST LENGTH	6'	Southern Pine	1-2x6	1-2x6	1-2x6	2-2x6	2-2x6	2-2x6	2-2x8	2-2x8	2-2x10	2-2x10	2-2x10	2-2x10	2-2x12	2-2x10
		Ponderosa Pine	1-2x6	1-2x6	1-2x8	2-2x8	2-2x8	2-2x8	2-2x8	2-2x10	2-2x10	2-2x12	2-2x12	2-2x12	2-2x12	3-2x10
		Corner Footing Intermediate Footing	6 5 4 9 8 7	7 6 5 10 8 7	7 6 5 10 9 7	8 7 5 11 9 8	9 7 6 12 10 9	9 7 6 13 10 9	10 8 7 14 11 10	10 8 7 14 12 10	10 9 7 15 12 10	11 9 8 15 13 11	11 9 8 16 13 11	11 9 8 17 14 12	11 9 8 18 15 13	11 9 8 19 16 14
	7'	Southern Pine	1-2x6	1-2x6	1-2x6	2-2x6	2-2x6	2-2x8	2-2x8	2-2x10	2-2x10	2-2x10	2-2x10	2-2x12	2-2x10	2-2x12
		Ponderosa Pine	1-2x6	1-2x6	1-2x8	2-2x8	2-2x8	2-2x8	2-2x10	2-2x10	2-2x12	2-2x12	2-2x12	2-2x12	3-2x10	3-2x10
		Corner Footing Intermediate Footing	7 5 5 9 8 7	7 6 5 10 8 7	8 7 6 11 9 8	9 7 6 12 10 9	9 8 7 13 11 9	10 8 7 14 11 10	10 8 7 15 12 10	11 9 8 15 13 11	11 9 8 16 13 11	11 9 8 17 14 12	12 10 9 17 14 12	12 10 9 18 15 13	12 10 9 19 16 14	12 10 9 20 17 15
	8'	Southern Pine	1-2x6	1-2x6	2-2x6	2-2x6	2-2x8	2-2x8	2-2x8	2-2x10	2-2x10	2-2x10	2-2x10	2-2x12	2-2x12	2-2x12
		Ponderosa Pine	1-2x6	2-2x6	2-2x8	2-2x8	2-2x8	2-2x10	2-2x10	2-2x10	2-2x10	2-2x12	2-2x12	2-2x12	3-2x10	3-2x10
		Corner Footing Intermediate Footing	7 6 5 10 8 7	8 6 6 11 9 8	9 7 6 12 10 9	9 8 7 13 11 9	10 8 7 14 11 10	10 8 7 15 12 10	11 9 8 16 13 11	11 9 8 16 13 12	12 10 9 17 14 12	13 10 9 18 15 13	13 10 9 18 15 13	13 11 9 19 16 14	13 11 9 20 17 15	
	9'	Southern Pine	1-2x6	1-2x6	2-2x6	2-2x6	2-2x8	2-2x8	2-2x10	2-2x10	2-2x10	2-2x12	2-2x12	2-2x12	3-2x10	3-2x10
		Ponderosa Pine	1-2x6	2-2x6	2-2x8	2-2x8	2-2x10	2-2x10	2-2x10	2-2x10	3-2x10	3-2x10	3-2x12	3-2x12	3-2x12	Eng Bm
		Corner Footing Intermediate Footing	7 6 5 10 9 7	8 7 6 12 10 8	9 7 6 13 10 9	10 8 7 14 11 10	10 9 7 15 12 10	11 9 8 16 13 11	11 9 8 17 14 12	12 10 8 17 14 12	12 10 9 18 15 13	13 10 9 19 16 14	13 11 9 20 17 15	13 11 9 21 18 16	14 11 10 22 19 17	
	10'	Southern Pine	1-2x6	1-2x6	2-2x6	2-2x6	2-2x8	2-2x8	2-2x10	2-2x10	2-2x12	2-2x12	2-2x12	3-2x10	3-2x10	3-2x10
		Ponderosa Pine	1-2x6	1-2x6	2-2x8	2-2x8	2-2x10	2-2x10	2-2x12	2-2x12	3-2x10	3-2x10	3-2x12	3-2x12	3-2x12	Eng Bm
		Corner Footing Intermediate Footing	8 6 6 11 9 8	9 7 6 12 10 9	10 8 7 14 11 10	10 8 7 15 12 10	11 9 8 16 13 11	12 10 8 17 14 12	12 10 8 17 14 12	12 10 9 18 15 13	13 11 9 18 15 13	14 11 10 19 16 14	14 12 10 20 17 15	14 12 10 21 18 16	15 12 10 22 19 17	
	11'	Southern Pine	1-2x6	2-2x6	2-2x6	2-2x8	2-2x8	2-2x10	2-2x10	2-2x12	2-2x12	2-2x12	3-2x10	3-2x10	3-2x12	3-2x12
Ponderosa Pine		2-2x6	2-2x6	2-2x8	2-2x8	2-2x10	2-2x12	2-2x12	3-2x10	3-2x10	3-2x12	3-2x12	3-2x12	3-2x12	Eng Bm	
Corner Footing Intermediate Footing		8 7 6 12 9 8	9 7 6 13 11 9	10 8 7 14 12 10	11 9 8 15 12 10	12 9 8 16 13 11	12 10 9 17 14 12	13 11 9 18 15 13	14 11 10 19 16 14	14 12 10 20 17 15	15 12 10 21 18 16	15 12 10 22 19 17	15 13 11 23 18 16	15 13 11 24 19 17		
12'	Southern Pine	1-2x6	2-2x6	2-2x6	2-2x8	2-2x8	2-2x10	2-2x10	2-2x12	2-2x12	3-2x10	3-2x10	3-2x12	3-2x12	3-2x12	
	Ponderosa Pine	2-2x6	2-2x6	2-2x8	2-2x10	2-2x10	2-2x12	2-2x12	3-2x10	3-2x10	3-2x12	3-2x12	3-2x12	3-2x12	Eng Bm	
	Corner Footing Intermediate Footing	9 7 6 12 10 9	10 8 7 14 11 10	10 9 7 15 12 10	11 9 8 16 13 11	12 10 9 17 14 12	13 10 9 18 15 13	14 11 10 19 16 14	14 12 10 20 17 15	15 12 10 21 18 16	15 13 11 22 19 17	16 13 11 23 18 16	16 13 11 24 19 17	16 13 11 25 20 18		
13'	Southern Pine	1-2x6	2-2x6	2-2x6	2-2x8	2-2x8	2-2x10	2-2x10	2-2x12	2-2x12	3-2x10	3-2x10	3-2x12	3-2x12	3-2x12	
	Ponderosa Pine	2-2x6	2-2x6	2-2x8	2-2x10	2-2x12	2-2x12	3-2x10	3-2x10	3-2x12	3-2x12	3-2x12	3-2x12	3-2x12	Eng Bm	
	Corner Footing Intermediate Footing	9 7 6 13 10 9	10 8 7 14 12 10	11 9 3 15 13 11	12 10 8 17 14 12	13 10 9 18 15 13	13 11 9 19 15 13	14 12 10 20 16 14	15 12 10 21 17 15	15 13 11 22 18 15	16 13 11 23 19 16	16 13 11 24 19 17	17 14 12 25 20 18	17 14 12 26 21 19		
14'	Southern Pine	1-2x6	2-2x6	2-2x6	2-2x8	2-2x10	2-2x10	2-2x12	3-2x10	3-2x10	3-2x12	3-2x12	3-2x12	3-2x12	3-2x12	
	Ponderosa Pine	2-2x6	2-2x8	2-2x8	2-2x10	2-2x12	3-2x10	3-2x10	3-2x12	3-2x12	3-2x12	3-2x12	3-2x12	3-2x12	Eng Bm	
	Corner Footing Intermediate Footing	9 8 7 13 11 9	10 8 7 15 12 10	11 9 8 16 13 11	12 10 9 17 14 12	13 11 9 18 15 13	14 11 10 20 16 14	15 12 10 21 17 15	15 13 11 22 18 15	16 13 11 23 18 16	17 14 12 24 19 17	17 14 12 25 20 18	17 14 12 26 21 19	17 14 12 27 22 20		
15'	Southern Pine	2-2x6	2-2x6	2-2x8	2-2x8	2-2x10	2-2x10	2-2x12	3-2x10	3-2x10	3-2x12	3-2x12	3-2x12	3-2x12	Eng Bm	
	Ponderosa Pine	2-2x6	2-2x8	2-2x8	2-2x10	3-2x10	3-2x10	3-2x12	3-2x12	3-2x12	3-2x12	3-2x12	3-2x12	3-2x12	Eng Bm	
	Corner Footing Intermediate Footing	10 8 7 14 11 10	11 9 8 15 12 11	12 10 8 17 14 12	13 10 9 18 15 13	14 11 10 19 16 14	14 12 10 20 17 14	15 12 11 21 17 15	16 13 11 22 18 16	17 14 12 23 19 17	17 14 12 24 20 17	17 14 12 25 21 18	18 15 13 26 22 19	18 15 13 27 23 20		
16'	Southern Pine	2-2x6	2-2x6	2-2x8	2-2x8	2-2x10	2-2x12	2-2x12	3-2x10	3-2x10	3-2x12	3-2x12	3-2x12	3-2x12	Eng Bm	
	Ponderosa Pine	2-2x6	2-2x8	2-2x10	2-2x10	3-2x10	3-2x10	3-2x12	3-2x12	3-2x12	3-2x12	3-2x12	3-2x12	3-2x12	Eng Bm	
	Corner Footing Intermediate Footing	10 8 7 14 11 10	11 9 8 15 13 11	12 10 9 17 14 12	13 11 9 18 15 13	14 11 10 20 16 14	15 12 10 21 17 15	15 13 11 22 18 16	16 13 12 23 19 16	17 14 12 24 20 17	18 15 13 25 21 18	18 15 13 26 22 19	18 15 13 27 23 20	18 15 13 28 24 21		

Notes:

- Joist length is total length of joist, including any cantilevers.
- When joist extends (cantilevers) beyond support beam by 18" or more, add 1" to footing dimensions shown.
- Requirements for future 3-season porches or screen porches:
 - Increase corner footing size shown by 90%.
 - Increase center footing size shown by 55%.
 - Locate all footings at extremities of deck (no cantilevers).
 - Beam sizes indicated need not be altered.
- All footing sizes above are base diameters (in inches) and are listed for THREE SOIL TYPES (see right)

Clay
Sand
Gravel

Corner Footing	10 8 7
Intermediate Footing	14 11 10

JOIST SPAN TABLE

Joist Sizes									
	Ponderosa Pine			Southern Pine			Western Cedar		
Joist Size	12" oc	16" oc	24" oc	12" oc	16" oc	24" oc	12" oc	16" oc	24" oc
2x6	9-2	8-4	7-0	10-9	9-9	8-6	9-2	8-4	7-3
2x8	12-1	10-10	8-10	14-2	12-10	11-0	12-1	11-0	9-2
2x10	15-4	13-3	10-10	18-0	16-1	13-5	15-5	13-9	11-3
2x12	17-9	15-5	12-7	21-9	19-0	15-4	18-5	16-0	13-0

BEAM SPAN TABLE

Joist Length		Post Spacing										
		4'	5'	6'	7'	8'	9'	10'	11'	12'	13'	14'
6'	Southern Pine Beam	2-2x6	2-2x6	2-2x6	2-2x6	2-2x6	2-2x6	2-2x8	2-2x8	2-2x10	2-2x10	2-2X10
	Ponderosa Pine Beam	2-2x6	2-2x6	2-2x8	2-2x8	2-2x8	2-2x8	2-2x10	2-2x10	2-2x10	2-2x12	2-2x12
7'	Southern Pine Beam	2-2x6	2-2x6	2-2x6	2-2x6	2-2x6	2-2x8	2-2x8	2-2x10	2-2x10	2-2x10	2-2X12
	Ponderosa Pine Beam	2-2x6	2-2x6	2-2x8	2-2x8	2-2x8	2-2x10	2-2x10	2-2x10	2-2x10	2-2x12	3-2x10
8'	Southern Pine Beam	2-2x6	2-2x6	2-2x6	2-2x6	2-2x8	2-2x8	2-2x8	2-2x10	2-2x10	2-2x12	2-2X12
	Ponderosa Pine Beam	2-2x6	2-2x6	2-2x8	2-2x8	2-2x8	2-2x10	2-2x10	2-2x10	3-2x10	3-2x10	3-2X12
9'	Southern Pine Beam	2-2x6	2-2x6	2-2x6	2-2x6	2-2x8	2-2x8	2-2x10	2-2x10	2-2x12	2-2x12	3-2X10
	Ponderosa Pine Beam	2-2x6	2-2x6	2-2x8	2-2x8	2-2x10	2-2x10	2-2x10	3-2x10	3-2x10	3-2x12	3-2X12
10'	Southern Pine Beam	2-2x6	2-2x6	2-2x6	2-2x6	2-2x8	2-2x8	2-2x10	2-2x10	2-2x12	3-2x10	3-2X10
	Ponderosa Pine Beam	2-2x6	2-2x6	2-2x8	2-2x8	2-2x10	2-2x10	2-2x12	3-2x10	3-2x12	3-2x12	ENG BM
11'	Southern Pine Beam	2-2x6	2-2x6	2-2x6	2-2x8	2-2x8	2-2x10	2-2x10	2-2x12	2-2x12	3-2x10	3-2X12
	Ponderosa Pine Beam	2-2x6	2-2x6	2-2x8	2-2x8	2-2x10	2-2x12	2-2x12	3-2x10	3-2x12	3-2x12	ENG BM
12'	Southern Pine Beam	2-2x6	2-2x6	2-2x6	2-2x8	2-2x8	2-2x10	2-2x10	2-2x12	3-2x10	3-2x10	3-2X12
	Ponderosa Pine Beam	2-2x6	2-2x6	2-2x8	2-2x10	2-2x10	2-2x12	2-2x12	3-2x12	3-2x12	ENG BM	ENG BM
13'	Southern Pine Beam	2-2x6	2-2x6	2-2x6	2-2x8	2-2x8	2-2x10	2-2x10	2-2x12	3-2x10	3-2X12	3-2X12
	Ponderosa Pine Beam	2-2x6	2-2x6	2-2x8	2-2x10	2-2x12	2-2x12	2-2x12	3-2x12	3-2x12	ENG BM	ENG BM
14'	Southern Pine Beam	2-2x6	2-2x6	2-2x6	2-2x8	2-2x10	2-2x10	2-2x12	2-2x12	3-2x12	3-2X12	3-2X12
	Ponderosa Pine Beam	2-2x6	2-2x6	2-2x8	2-2x10	2-2x12	3-2x10	3-2x12	3-2x12	ENG BM	ENG BM	ENG BM
15'	Southern Pine Beam	2-2x6	2-2x6	2-2x8	2-2x8	2-2x10	2-2x10	2-2x12	3-2x10	3-2x12	3-2X12	ENG BM
	Ponderosa Pine Beam	2-2x6	2-2x8	2-2x8	2-2x10	3-2x10	3-2x10	3-2x12	3-2x12	ENG BM	ENG BM	ENG BM
16'	Southern Pine Beam	2-2x6	2-2x6	2-2x8	2-2x8	2-2x10	2-2x12	2-2x12	3-2x10	3-2x12	3-2X12	ENG BM
	Ponderosa Pine Beam	2-2x6	2-2x8	2-2x10	2-2x10	3-2x10	3-2x10	3-2x12	3-2x12	ENG BM	ENG BM	ENG BM

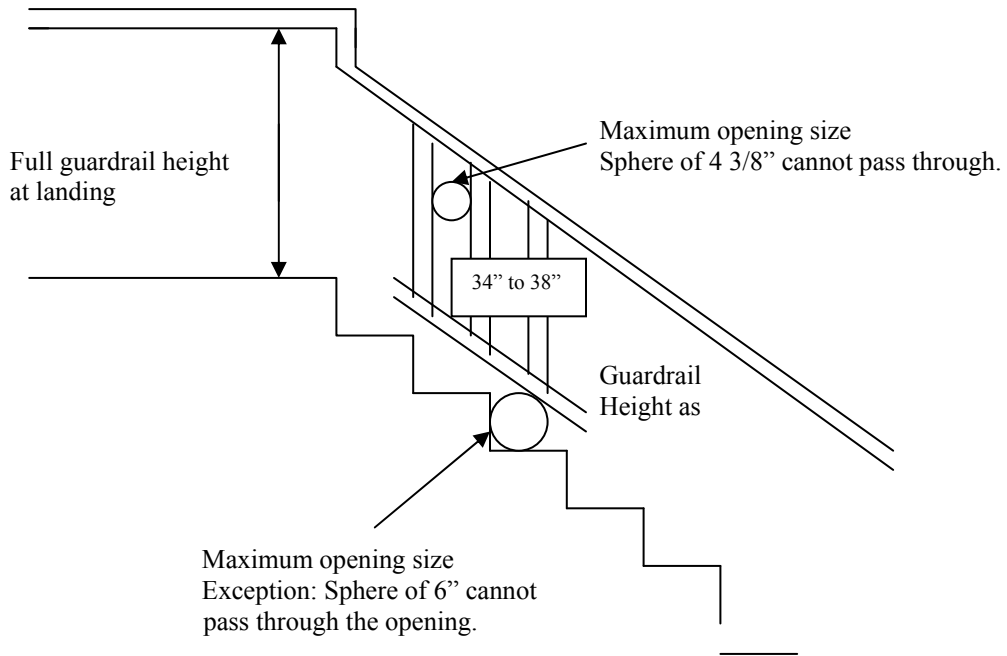

$x = 1 \frac{1}{4}"$ min, $2 \frac{5}{8}"$ max.

$y = 1 \frac{1}{2}"$ min

$z = 3 \frac{1}{2}"$ max.

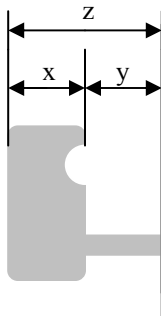
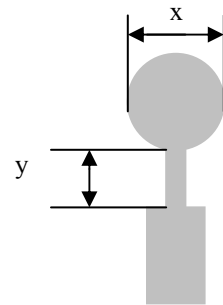
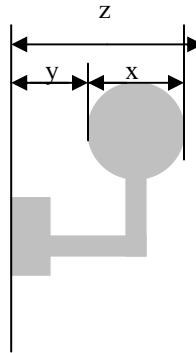
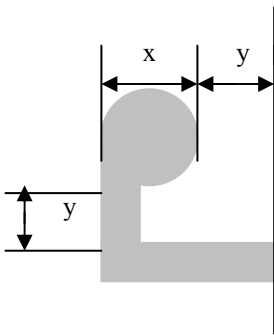

NOT ACCEPTABLE

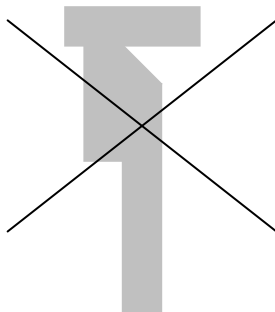

NOT ACCEPTABLE

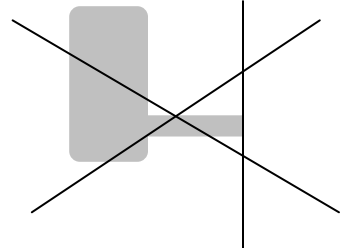

Measured from stairway
front edge of nosing

Handrail shall be made continuous.
(See information sheet)

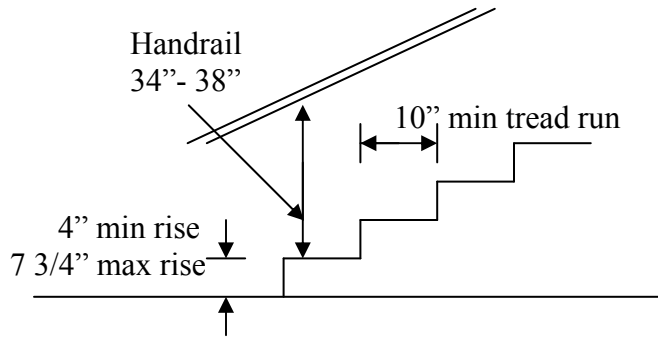

Open risers are permitted, provided that the opening between treads does not permit the passage of a 4-inch diameter sphere.

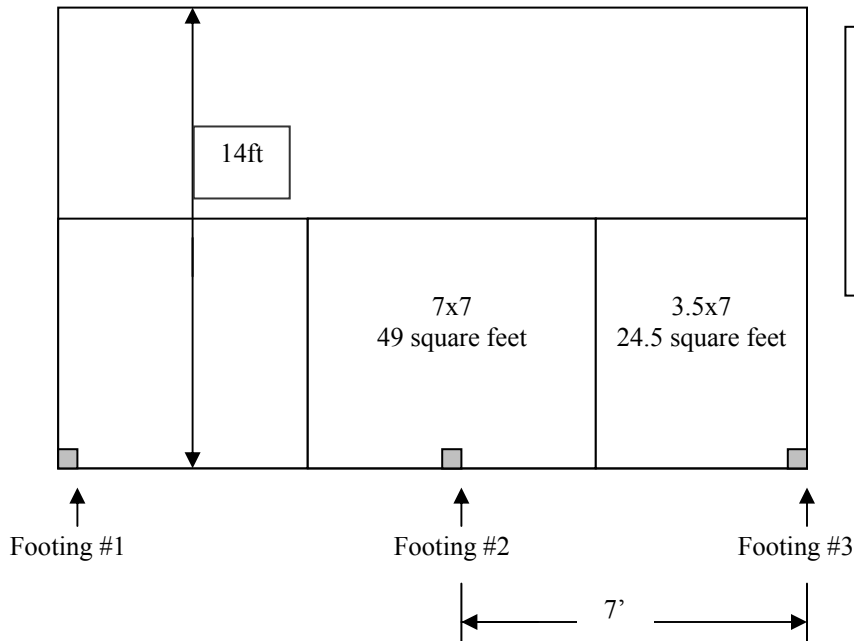

Assumed Allowable
Foundation Pressure =
2000 lbs/ sq. ft.

Floor Load =
40 lbs/ sq. ft.

Example Calculation

Footing 1 and 3

Circle
 $24.5 \text{ sq. ft} \times 40 = 980 \text{ lbs}$
 $980 \div 2000 \text{ lbs} = .49 \text{ sq ft area}$
 $.49 \div 3.14 = .156$
 $\sqrt{.156} = .395$
 $.395 \div .083 = 4.758 \times 2 = 9.5''$
= 10'' diameter

Footing 2

Circle
 $49 \text{ sq ft} \times 40 = 1960 \text{ lbs}$
 $1960 \div 2000 \text{ lbs} = .98 \text{ sq ft area}$
 $.98 \div 3.14 = .313$
 $\sqrt{.313} = .56$
 $.56 \div 0.083 = 6.75 \times 2 = 13.49''$
= 13'' diameter

CITY EXAMPLE PLAN

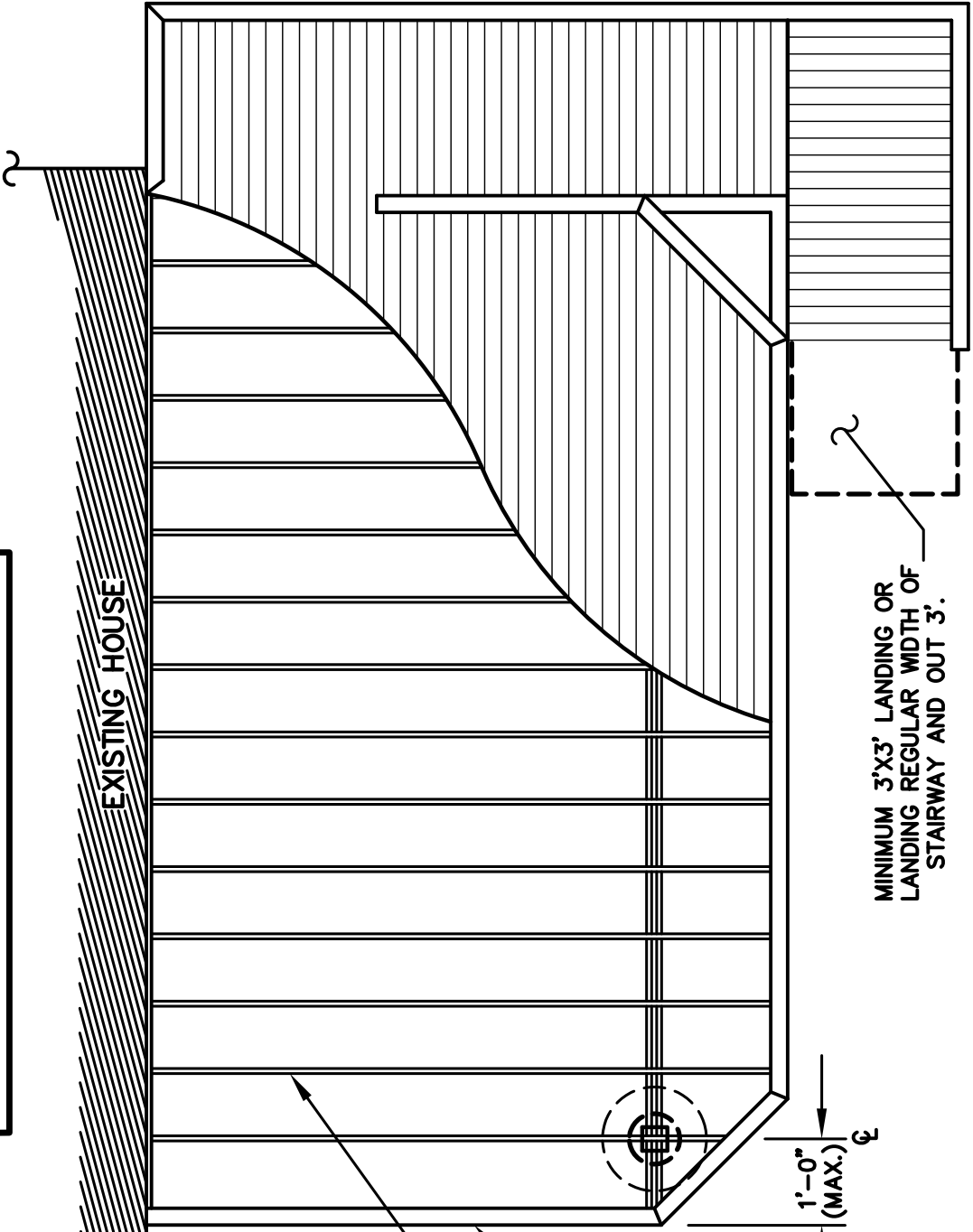

DECKS SHALL NOT BE ATTACHED TO ANY EXISTING CANTILEVERS WITHOUT PRIOR APPROVAL FROM THE CITY.

TREATED JOISTS 16" O.C.

TREATED BEAM

2'-0" (MAX.)

1'-0" (MAX.)

MINIMUM 3'X3' LANDING OR LANDING REGULAR WIDTH OF STAIRWAY AND OUT 3.'

STAIRWAY ILLUMINATION SHALL BE REQUIRED.

ALL DRAWINGS MUST BE TO SCALE.

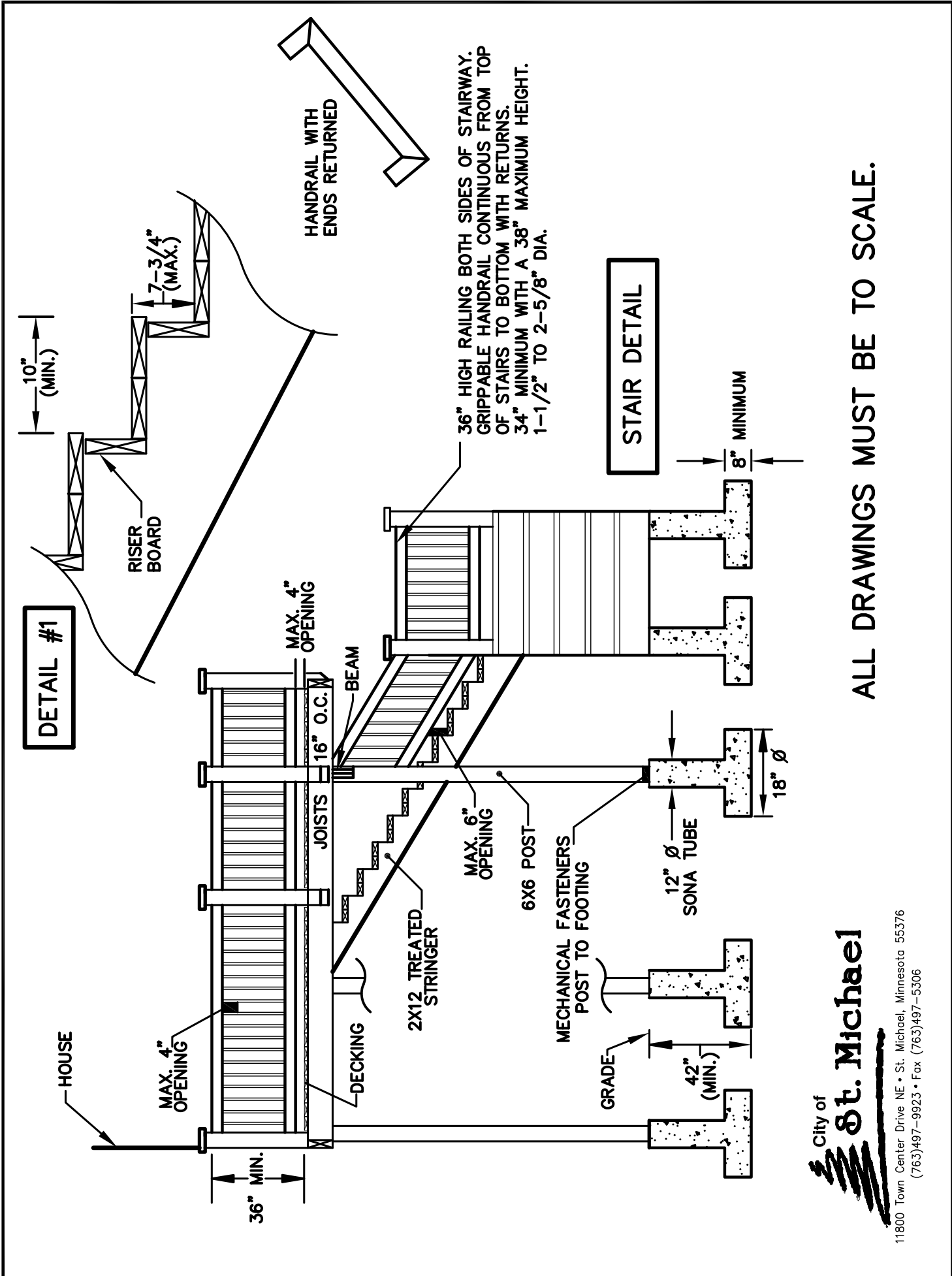

ALL DRAWINGS MUST BE TO SCALE.

DETAIL #2

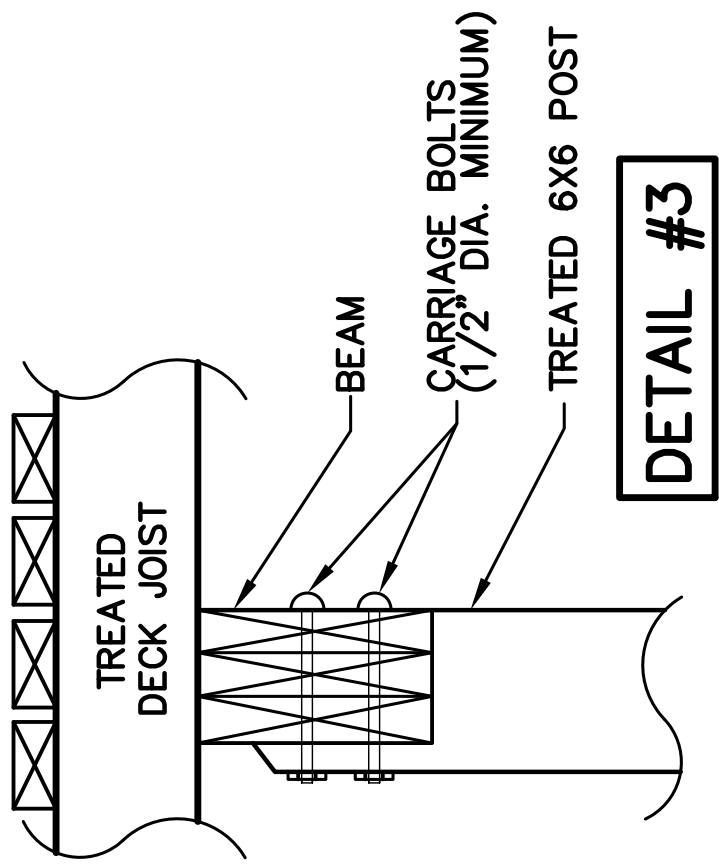
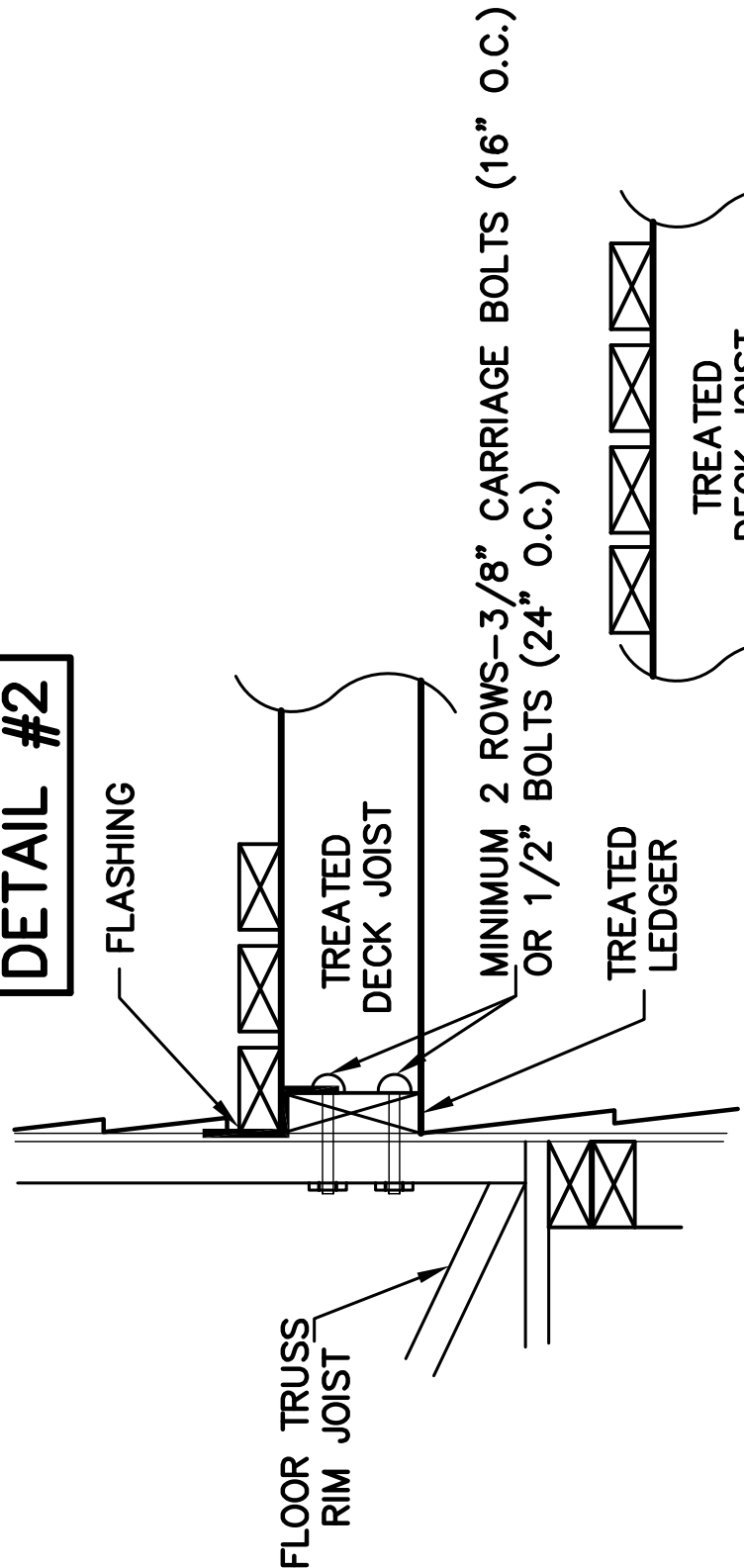

DETAIL #3

ALL DRAWINGS MUST BE TO SCALE.



11800 Town Center Drive NE, Suite 300
St. Michael, MN 55376
Phone: 763-497-9923
inspections@stmichaelmn.gov

Permit No. _____

Date _____

BUILDING PERMIT APPLICATION

SITE ADDRESS: _____

LEGAL DESCRIPTION: LOT _____ BLOCK _____ ADDITION _____

PROPERTY OWNER NAME: _____ PHONE: _____

ADDRESS: _____ CITY: _____ STATE _____ ZIP: _____

APPLICANTS EMAIL ADDRESS: _____

CONTRACTOR NAME: _____ PHONE: _____

STATE LICENSE: _____ EMAIL: _____

ADDRESS: _____ CITY: _____ STATE: _____ ZIP: _____

PLUMBER NAME: _____ PHONE: _____

ADDRESS: _____ CITY: _____ STATE: _____ ZIP: _____

MECHANICAL NAME: _____ PHONE: _____

ADDRESS: _____ CITY: _____ STATE: _____ ZIP: _____

GAS NAME: _____ PHONE: _____

ADDRESS: _____ CITY: _____ STATE: _____ ZIP: _____

FIREPLACE NAME: _____ PHONE: _____

ADDRESS: _____ CITY: _____ STATE: _____ ZIP: _____

TYPE OF WORK

- Checkboxes for: New Construction, Alterations / Remodel, Addition, Finish Basement, Residing, Repair, Porch, Garage, Deck, Reroof, Other: _____

TYPE OF CONSTRUCTION

- Checkboxes for: Single Family, Duplex, Multi-Family

BUILDING INFORMATION

Use of Building: _____ # of Stories: _____

Floor area sq. ft.: _____

Estimated Value of Construction: _____ Description of Work: _____

**SPECIAL CONDITIONS: IT IS MY RESPONSIBILITY TO LOCATE AND ESTABLISH THE ELEVATIONS, IF NEEDED, OF ALL SITE IMPROVEMENTS. REQUIRED ADJUSTMENTS AT MY EXPENSE.

APPLICANT: Please show fixtures that are applicable

<p><u>Mechanical: (if applicable)</u></p> <table style="width:100%; border-collapse: collapse;"> <tr> <th style="width:10%;"><u>No.</u></th> <th><u>Fixture Type</u></th> </tr> <tr><td>_____</td><td>A/C</td></tr> <tr><td>_____</td><td>Air to Air Exchanger</td></tr> <tr><td>_____</td><td>Residential Hood</td></tr> <tr><td>_____</td><td>Duct Work</td></tr> <tr><td>_____</td><td>Furnace</td></tr> <tr><td>_____</td><td>Boiler</td></tr> <tr><td>_____</td><td>In Floor Heat</td></tr> <tr><td>_____</td><td>Pool Heater</td></tr> <tr><td>_____</td><td>Solar</td></tr> <tr><td>_____</td><td>Unit Heater</td></tr> <tr><td>_____</td><td>Other _____</td></tr> </table> <p>Valuation: \$ _____</p> <p>Residential - 1 1/2% Total Job Valuation*-min. of \$75</p> <p>Surcharge: .0005 x total Job Valuation</p>	<u>No.</u>	<u>Fixture Type</u>	_____	A/C	_____	Air to Air Exchanger	_____	Residential Hood	_____	Duct Work	_____	Furnace	_____	Boiler	_____	In Floor Heat	_____	Pool Heater	_____	Solar	_____	Unit Heater	_____	Other _____	<p><u>Plumbing: (if applicable)</u></p> <table style="width:100%; border-collapse: collapse;"> <tr> <th style="width:10%;"><u>No.</u></th> <th><u>Fixture Type</u></th> </tr> <tr><td>_____</td><td>Bathtub</td></tr> <tr><td>_____</td><td>Clothes Washer</td></tr> <tr><td>_____</td><td>Dishwasher</td></tr> <tr><td>_____</td><td>Floor Drains</td></tr> <tr><td>_____</td><td>Kitchen Sink / Disposal</td></tr> <tr><td>_____</td><td>Lavatory</td></tr> <tr><td>_____</td><td>Lavatory Rough in</td></tr> <tr><td>_____</td><td>Roof Drains</td></tr> <tr><td>_____</td><td>Sewage Pump</td></tr> <tr><td>_____</td><td>Sewer / Water</td></tr> <tr><td>_____</td><td>Shower</td></tr> <tr><td>_____</td><td>Utility Sink</td></tr> <tr><td>_____</td><td>Sump Pump / Radon</td></tr> <tr><td>_____</td><td>Swim Pool</td></tr> <tr><td>_____</td><td>Sprinkler System (PVB)</td></tr> <tr><td>_____</td><td>Water Closet (toilet)</td></tr> <tr><td>_____</td><td>Water Heater</td></tr> <tr><td>_____</td><td>Water Meter</td></tr> <tr><td>_____</td><td>Water Softener</td></tr> <tr><td>_____</td><td>Other _____</td></tr> </table> <p>_____ Total Openings</p> <p>Residential - \$75 for the 1st opening -\$8 for each additional</p> <p>Surcharge: Residential - \$1.00, Commercial - .0005 x total Job Valuation</p>	<u>No.</u>	<u>Fixture Type</u>	_____	Bathtub	_____	Clothes Washer	_____	Dishwasher	_____	Floor Drains	_____	Kitchen Sink / Disposal	_____	Lavatory	_____	Lavatory Rough in	_____	Roof Drains	_____	Sewage Pump	_____	Sewer / Water	_____	Shower	_____	Utility Sink	_____	Sump Pump / Radon	_____	Swim Pool	_____	Sprinkler System (PVB)	_____	Water Closet (toilet)	_____	Water Heater	_____	Water Meter	_____	Water Softener	_____	Other _____	<p><u>Permit Fees:</u></p> <p>Permit Fee: _____</p> <p>Surcharge Fee: _____</p> <p>Plan Review Fee: _____</p> <p>Water Inspection Fee: _____</p> <p>Sewer Inspection Fee: _____</p> <p>Water Meter Fee: _____</p> <p>Water Fee: _____</p> <p>Sewer Fee: _____</p> <p>Contractors License: _____</p> <p>Erosion Control Escrow: _____</p> <p>Trunk Fee: _____</p> <p>PRV: _____</p> <p>Penalty Fee: _____</p> <p>Mechanical Fee: _____</p> <p>Mechanical Surcharge Fee: _____</p> <p>Gas Fee: _____</p> <p>Gas Surcharge Fee: _____</p> <p>Gas Fireplace Fee: _____</p> <p>Gas Fireplace Surcharge Fee: _____</p> <p>Plumbing Fee: _____</p> <p>Plumbing Surcharge Fee: _____</p> <p>Other Fee: _____</p> <p>Engineering Fee: _____</p> <p>Total Fees: _____</p>
<u>No.</u>	<u>Fixture Type</u>																																																																			
_____	A/C																																																																			
_____	Air to Air Exchanger																																																																			
_____	Residential Hood																																																																			
_____	Duct Work																																																																			
_____	Furnace																																																																			
_____	Boiler																																																																			
_____	In Floor Heat																																																																			
_____	Pool Heater																																																																			
_____	Solar																																																																			
_____	Unit Heater																																																																			
_____	Other _____																																																																			
<u>No.</u>	<u>Fixture Type</u>																																																																			
_____	Bathtub																																																																			
_____	Clothes Washer																																																																			
_____	Dishwasher																																																																			
_____	Floor Drains																																																																			
_____	Kitchen Sink / Disposal																																																																			
_____	Lavatory																																																																			
_____	Lavatory Rough in																																																																			
_____	Roof Drains																																																																			
_____	Sewage Pump																																																																			
_____	Sewer / Water																																																																			
_____	Shower																																																																			
_____	Utility Sink																																																																			
_____	Sump Pump / Radon																																																																			
_____	Swim Pool																																																																			
_____	Sprinkler System (PVB)																																																																			
_____	Water Closet (toilet)																																																																			
_____	Water Heater																																																																			
_____	Water Meter																																																																			
_____	Water Softener																																																																			
_____	Other _____																																																																			
<p><u>Gas: (if applicable)</u></p> <table style="width:100%; border-collapse: collapse;"> <tr> <th style="width:10%;"><u>No.</u></th> <th><u>Fixture Type</u></th> </tr> <tr><td>_____</td><td>Dryer</td></tr> <tr><td>_____</td><td>Fireplace (gas)</td></tr> <tr><td>_____</td><td>Pool Heater</td></tr> <tr><td>_____</td><td>Water Heater</td></tr> <tr><td>_____</td><td>Roof Top</td></tr> <tr><td>_____</td><td>Grill & BBQ</td></tr> <tr><td>_____</td><td>Range</td></tr> <tr><td>_____</td><td>Unit Heater</td></tr> <tr><td>_____</td><td>Furnace</td></tr> <tr><td>_____</td><td>Other _____</td></tr> </table> <p>Valuation: \$ _____</p> <p>Residential - 1 1/2% Total Job Valuation*-min. of \$75</p> <p>Surcharge: .0005 x total Job Valuation</p>	<u>No.</u>	<u>Fixture Type</u>	_____	Dryer	_____	Fireplace (gas)	_____	Pool Heater	_____	Water Heater	_____	Roof Top	_____	Grill & BBQ	_____	Range	_____	Unit Heater	_____	Furnace	_____	Other _____	<p><u>Gas Fireplace: (if applicable)</u></p> <table style="width:100%; border-collapse: collapse;"> <tr> <th style="width:10%;"><u>No.</u></th> <th><u>Fixture Type</u></th> </tr> <tr><td>_____</td><td>Fireplace Openings</td></tr> </table> <p>Valuation: \$ _____</p> <p>Residential - 1 1/2% Total Job Valuation*-min. of \$75</p> <p>Surcharge: .0005 x total Job Valuation</p>	<u>No.</u>	<u>Fixture Type</u>	_____	Fireplace Openings																																									
<u>No.</u>	<u>Fixture Type</u>																																																																			
_____	Dryer																																																																			
_____	Fireplace (gas)																																																																			
_____	Pool Heater																																																																			
_____	Water Heater																																																																			
_____	Roof Top																																																																			
_____	Grill & BBQ																																																																			
_____	Range																																																																			
_____	Unit Heater																																																																			
_____	Furnace																																																																			
_____	Other _____																																																																			
<u>No.</u>	<u>Fixture Type</u>																																																																			
_____	Fireplace Openings																																																																			

Applicant Signature: _____ **Date:** _____

Approved by Planning: _____ **Date:** _____

Notes: _____

Approved by Engineering: _____ **Date:** _____

Notes: _____

Approved by Building Official: _____ **Date:** _____

CHECKLIST TO SUBMIT WITH DECK PERMIT APPLICATION

Please fill in each question and return with deck application.

1. Proposed size of deck _____
2. Height of deck from grade _____
3. Size and spacing of floor joists _____
4. Size of beam(s) _____
5. Type of decking material _____
6. Size of posts _____
7. Spacing between posts _____
8. Type of lumber using _____
9. Diameter of footings _____
10. Size of bell at bottom of footings _____
11. Height of guardrail _____
12. Copy of lot survey with proposed deck drawn to scale indicating location.